

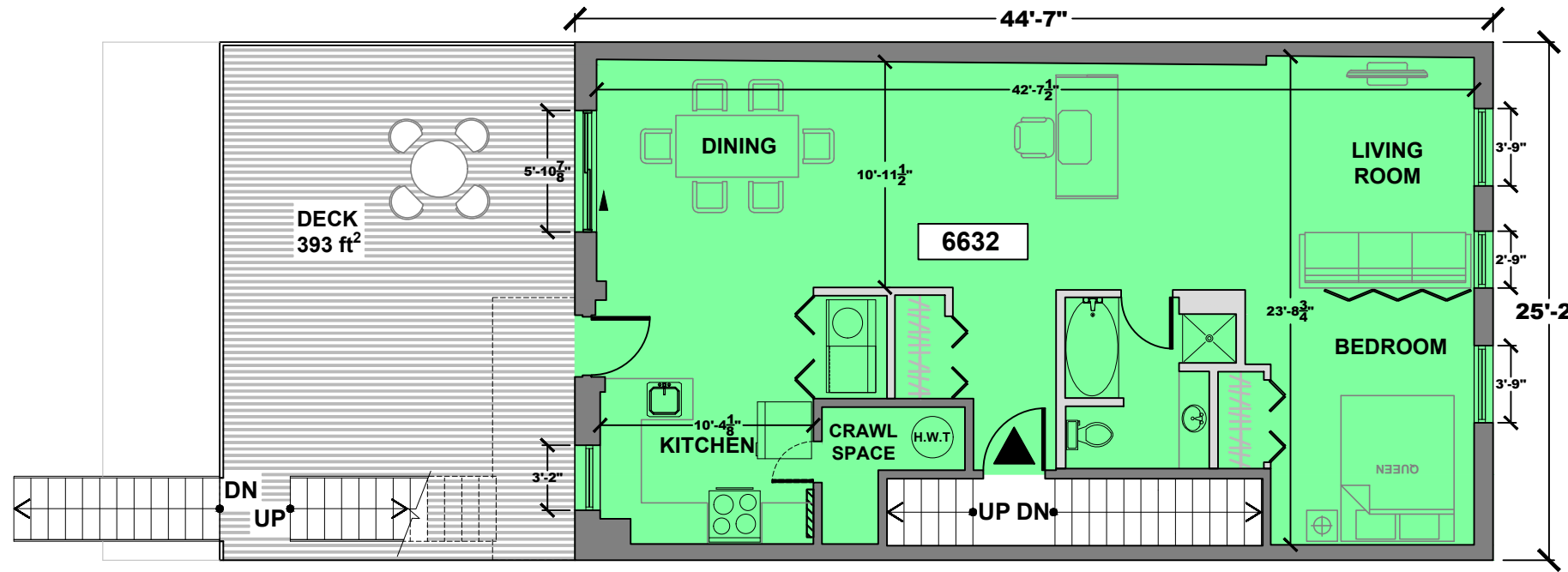

# RESIDENTIAL

## 6632 SAINT - HUBERT

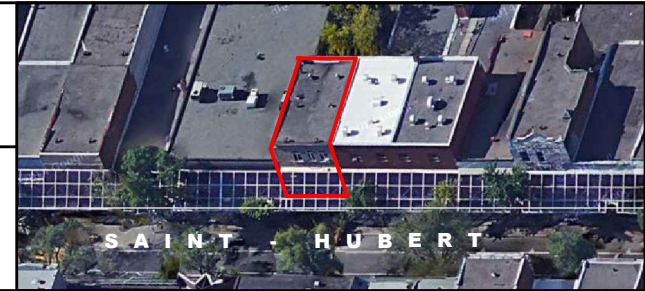

LAYOUT	LOFT
CEILING HEIGHT	±08' - 02"
<b>LEASABLE AREA</b>	<b>1,044 ft²</b>

SHILLER group  
 3510 boul. St-Joseph E.  
 Montréal, QC  
 H1X 1W6

**SHILLER GROUP**  
**S. J. SHILLER**

**2 N D F L O O R**

DATE (Y.M.D.) 2017-02-24	SCALE @ LEGAL 1/8" = 1'-0"	BUILDING 0059
-----------------------------	-------------------------------	------------------